

## Important Safety Information

Read and understand all safety precautions and instructions before use.

- The Brush Grubber HD Hitch Attachment is designed for outdoor use.
- Check Brush Grubber HD Hitch Attachment before each and every use for signs of wear. Do Not use if damaged or if not working properly
- The Brush Grubber HD Hitch Attachment is designed to use with ATV & UTV receiver hitches. Easily adapts to your existing Original Brush Grubber (Model BG-08) for fast one person operation
- The Brush Grubber HD Hitch Attachment is not to be used on people or pets.



Detent

## Instructions

1. Pull rope to open the jaws on the BG-08HA Hitch Attachment. will hold the jaws open until released.
2. Back up/pull forward until the brush/stump is in-between the grip pads of the BG-08 Brush Grubber HD
3. Pull the rope to release allowing the jaws to close on the brush/stump.
4. Pull forward/back up to pull the brush/stump, including the root system, out of the ground.
5. Pull the rope again to release the brush/stump from the jaws of the Brush Grubber HD.

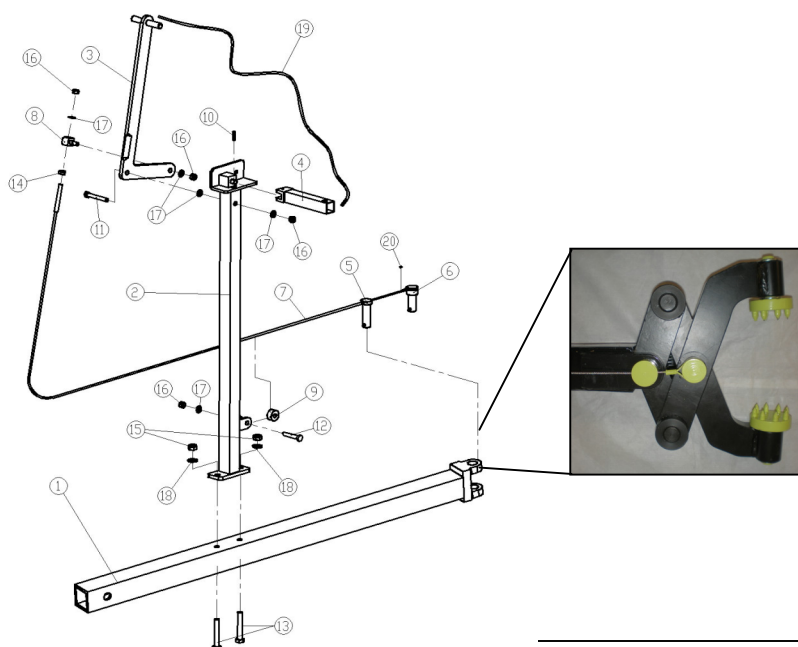

Ref. #	Qty	Part #	Description
1	1	BG-01A-01	Joint Staff
2	1	BG-01A-02	Joint Staff
3	1	BG-01A-03	Handle
4	1	BG-01A-04	Spanner
5	1	BG-08A-03	Center Shaft
6	1	BG-08A-04	Center Shaft
7	1	BG-01A-07	Wire Cable
8	1	BG-02-09	Square Bolt M6
9	1	BG-02-06	Roller
10	1	GB/T879.2	Roll Pins 3*16
11	1	GB/T5782-2000	Hex Bolt M6*45*20
12	1	GB/T5783-2000	Hex Bolt M6*35
13	2	GB/T5782-2000	Hex Bolt M8*75*25
14	1	GB/T6170-2000	Nut M6
15	2	GB/T889.1-2000	Lock Nut M8
16	4	GB/T889.1-2000	Lock Nut M6
17	5	GB/T95-1985	Washer φ6*12*0.5
18	2	GB/T95-1985	Washer φ8*16*1
19	1	GB896-86	Nylon Line φ7
20	1		Nip φ2

### WARNING



BAC Industries, Inc. and Brush Grubber will not be held liable for any damages, losses, or injury, due to misapplication or misuse of this product or for any other reason. Always wear approved safety glasses, protective clothing, and proper hand and foot protection at all times. Keep all people and pets or animals clear from brush removal work area.

BrushGrubber.com  
PO BOX 5064  
HOPKINS, MN

PH: 952-938-9058

[www.brushgrubber.com](http://www.brushgrubber.com)

Email:

See other unique items at [BrushGrubber.com](http://BrushGrubber.com)